



## Technical Information



40 Tie lines	8 stage right 24 stage left 8 rear stage	
Allen & Heath GL 2200-432 32 channel desk	Seck 12-8-2	HH V800 (FOH)
Tandy 100w stereo amp	(mpa-100)	on stage speakers
Twin cassette deck		
CD player		
MD player	Sony MDS-E10	
Metro Audio ring system 6 ways inc master station		
Metro Audio SMAC	For dressing room/backstage/FOH calls	
Radio mics/SM58 mics		
Jem ZR22 smoke machines	2 x DMX and manual controller	
Music and conductor stands		



3 off 1 phase 32 amp on fly gallery stage left		
Lighting control Zero 88 Fat Frog	26 channels on stage	14 on pros 4 on cyc 8 at stage level
	24 channels FOH	
Patch panels FOH and on-stage		
Follow spots	2 x solo 2k Operator controlled dimmers and colour changers	
Movable lanterns	12 x Harmony 22/40 2 x Canata15/22 4 x Canata 22/40 14 x 743 2 x Prelude Profile 2 x Prelude PC 2 x Prelude F	
	10 x Minim F 12 x Par Cans 12 x PAR 16 birdies 6 x Patt 137 12 x Patt 23 2 x Patt 23N	
	12 x ChromaqM1 scrollers and plates for Canata, PAR and 743	





# Stage Area

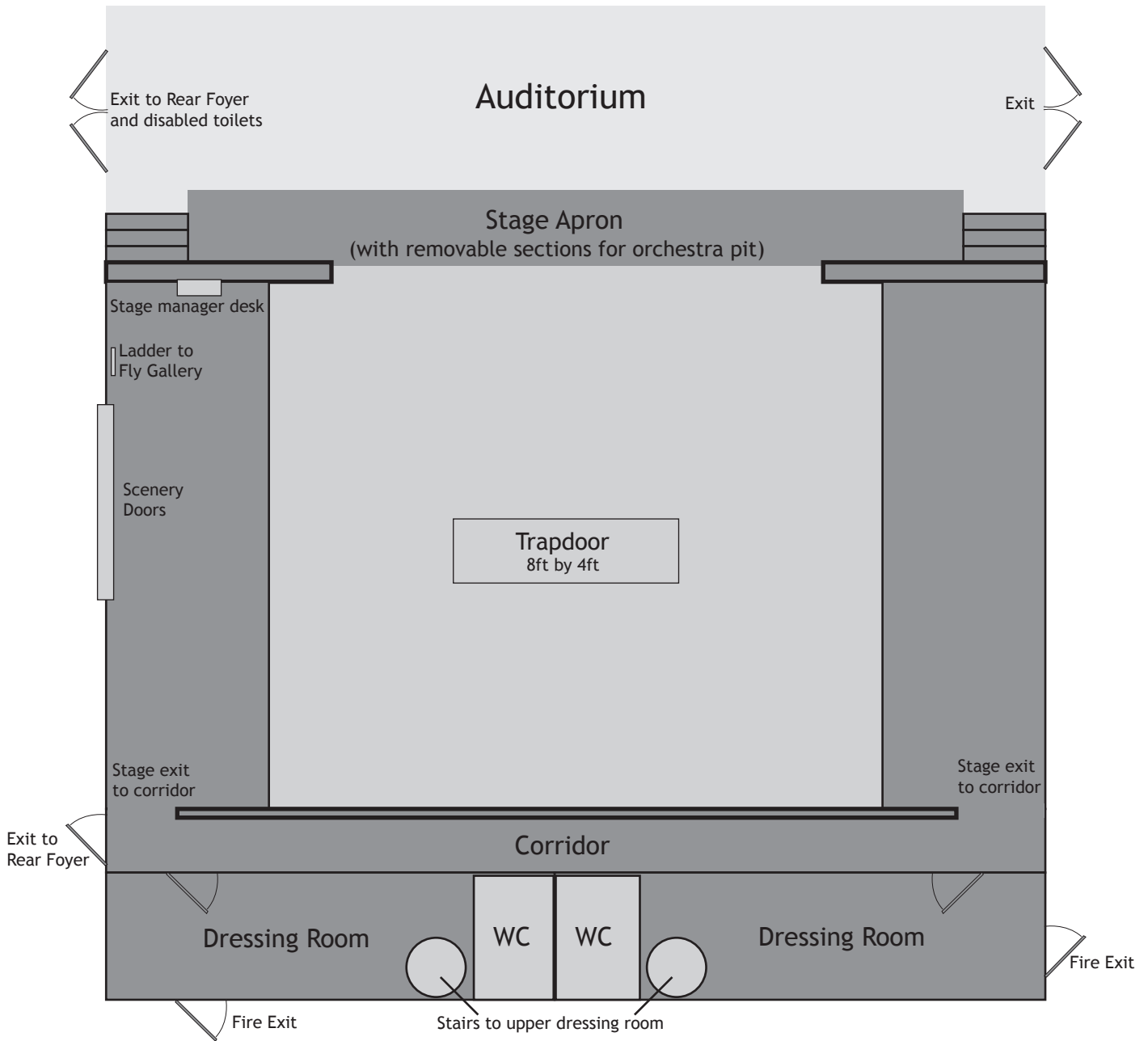

Please note: Drawing not to scale

Size of proscenium: 30ft width 14ft height

Depth of stage 20ft - wing space 10 ft each side

Height to grid 16ft - 10 hemp lines approx 1ft apart - 4 lighting bars on winches - front of house lighting bar with side bars

House tabs, cyc, 4 black borders and leg sets

Dressings rooms – 2 lower and 2 upper (access through lower dressing rooms) with additional rehearsal rooms in the extension that can be used as dressing rooms.

